

REV.	ECR	DESCRIPTION	DATE
A	17806	INITIAL DRAWING REQUEST	04/01/2021

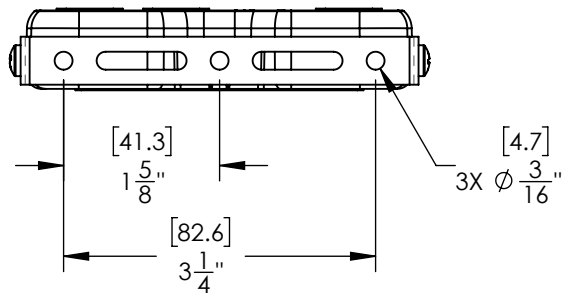
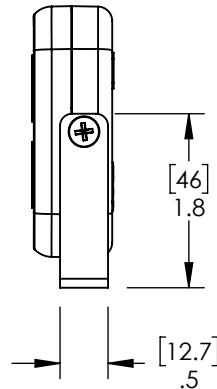
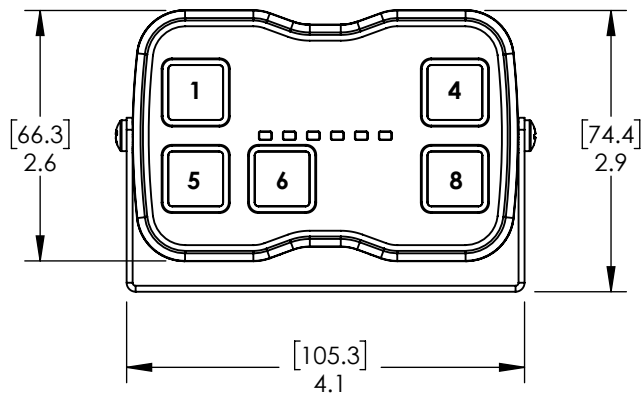
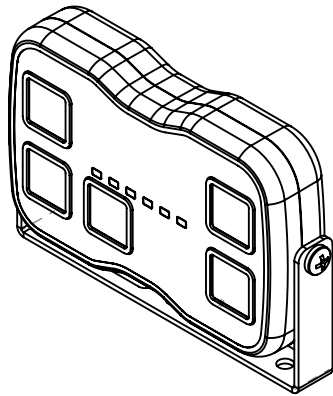

**SPECIFICATIONS:**

- OPERATING RANGE: 9-16VDC
- NOMINAL VOLTAGE: 12 VDC
- OUTPUT CURRENT: 12.8VDC 2@2.5A, 2@0.06A
- 6 LED SIMULATED TRAFFIC DIRECTOR FEEDBACK (LEFT, RIGHT, CENTER OUT, WARN)
- PROGRAMMABLE OPTIONS
- OPERATING TEMPERATURE RANGE: -40F (-40C) TO 131F (55C)

**CONNECTIONS:**

- 12" LONG 18AWG RED WIRE (POWER +)
- 12" LONG 22AWG BLACK WIRE (GROUND -)
- 12" LONG 22AWG YELLOW WIRE (PB 4)
- 12" LONG 22AWG GREEN WIRE (PB 5)
- 12" LONG 22AWG BLUE WIRE (PB 6)
- 12" LONG 22AWG BROWN WIRE (PB 8)

**INSTALLATION:**

- UNIVERSAL BRACKET 274-SB44-U (INCLUDED)
- HEADLINER BRACKET 274-SB44-H (OPTIONAL)
- #8-32 HARDWARE (BRACKET TO CONTROLLER)

**MATERIALS:**

- OUTER HOUSING: POLYCARBONATE
- KEYPAD: SILICONE RUBBER
- BRACKETS: ALUMINUM
- HARDWARE: STAINLESS STEEL
- BUTTON LABELS: VELVET FINISH LEXAN

**PRODUCT LABEL:**

- WHITE POLYESTER STOCK 3.0" X .375"
- COLOR STAR LOGO

**INDIVIDUAL PACKAGING:** APPROXIMATELY 142g(0.31 lb.)

- INDIVIDUAL BROWN BOXES
- MODEL INFORMATION PRINTED ON ON LABEL

**INSTRUCTION SHEET:**

- 1 PROVIDED (ENGLISH)

UNLESS OTHERWISE SPECIFIED DIMENSIONS ARE IN INCHES TOLERANCES: ANGULAR: ± 2 DEG. .X ± .100 .XX ± .020 .XXX ± .005 .XXXX ± .001	DRAWN BY: MD	<b>STAR HEADLIGHT &amp; LANTERN CO., INC.</b> 455 Rochester St. Avon NY 14414 Ph:(585) 226-9500 Fax: (585) 226-2029	
	DRAWING APPROVED BY ECR		
RoHS COMPLIANT: YES	THE INFORMATION CONTAINED IN THIS DRAWING IS THE SOLE PROPERTY OF STAR HEADLIGHT & LANTERN CO., INC.. ANY REPRODUCTION IN PART OR AS A WHOLE WITHOUT THE WRITTEN PERMISSION OF STAR HEADLIGHT & LANTERN CO., INC. IS STRICTLY PROHIBITED.		MODEL: SB44-5
MATERIAL: N/A			TITLE: SB44-5 MODEL DRAWING
FINISH: N/A	DWG. NO. SB44-5		REV A
	SCALE: 1:2	DO NOT SCALE FROM DRAWING	SHEET 1 OF 1